

WE
DELIVER



RUSYLVIA CATTLE CO.

Third Annual BULL SALE

MARCH 1, 2023 | 1PM | ON THE FARM AT DERWENT, AB

Welcome from **RUSYLVIA CATTLE CO.**



It is with great excitement and anticipation we welcome you to our 3rd Annual Bull Sale. Rusylvia Cattle Co. was established in 1994 when Ken and Josie got married, and so this year marks the 29th year of selling bulls. Rusylvia Cattle is made up of grain, hay and pasture-land along with 400 cows. Our purebred herds are Simmental, Black Angus and Maine Anjou with the majority being black hided. Our commercial herd is Angus x Maine, and Angus x Simmental. All the cows are managed the same way in regards to: herd health, graze grass until November, corn graze next until December, and cereal silage or silage bales during the calving period. We utilize natural heats to A.I. about 140 cows each spring and put in 40-50 embryos as well. The benefit list is long with A.I. and E.T. programs, and it truly gets exciting every calving to see the results. Josie and Riley both A.I. with Josie having taught A.I. to hundreds of people over the 15 plus years teaching A.I. at Lakeland College. The bulls on offer are from some of the leading genetics on offer in Canada and in the U.S.

We sometimes get asked why three breeds. Josie got her first Maine in 1981 and brought 40 head to Alberta in 1994. The Maine breed performance, quietness, hair and incredible mothering ability is what we appreciate the most. The Black Angus purebreds started in 2005 with purchases from Stretton Creek, Mountain View Farms and KBJ Dispersal. We loved the commercial Maine x Angus cross calves for their pounds at weaning time and felt the two breeds fit together well. The Simmental is the newest addition with our first purchases in 2015. The boys being active on the show road across western Canada really loved the excitement, people and what the Simmental breed had to offer. With key female purchases, leading A.I. sires and embryos, our program rapidly developed.

Rusylvia Cattle is truly a family-run operation with our boys growing up showing, running equipment and doing all things agriculture. We love the lifestyle, the challenges but mostly the rewarding relationships we've formed through so many avenues over the years. One of the great relationships we formed is part of this year's sale and that is with the Shologan family. Lee Shologan is an eager, enthusiastic, and keen young cattleman who we enjoy having come out to help at the farm and shows. He is truly part of our team here with a keen eye for cattle selection. There's no doubt he will be a force to be reckoned with in the future. As well, as we couldn't do without Bronwyn Frenzel who keeps

the guys and mostly Riley in line at the shows and Nick Wasylik is also invaluable to us and seems to take a beating but keeps coming back. Our heartfelt thanks to you all.

We had an incredible run with showing cattle in 2022. It started with the boys and partners Nick and Lee showing their steer and winning many banners/jackpots across western Canada. It seemed every weekend that truck and trailer were headed to a show. Then, the fall show road started in October, and we had a tremendous show at all four shows – Olds Fall Classic, Lloydminster Stockade RoundUp, Farmfair International at Edmonton and Agribition in Regina. Our crowning jewel is no doubt Mr Rusylvia 39J, which sold last year in our sale to 12 purebred and commercial beef producers. Our proudest achievement was Mr Rusylvia We Deliver 39J winning Grand Champion Bull at all four shows, Top 4 Supreme Bulls at Lloydminster and Top 10 At Agribition. The decision was made to make the trip to Denver for the National Western Stock Show and after eight days, 5000km, one Reserve Champion Banner and quite a few stories, they made it back safe. That show is an experience and dream for many producers, and winning that purple banner is an experience like no other.

Bull buyers, show families, junior families, fall sale supporters, and the list goes on, you are truly the best part of the business. Some of the best times are every year at Agribition, Stockade Round up, Farmfair, Olds Fall Classic, Calgary Stampede, Summer Synergy or the multitude of other events we've attended. There's nothing we love better than having a cooler of refreshments waiting when we get a call someone is stopping in to do a pasture tour or getting the coffee ready after the bull pens have been toured. To all our past bull buyers, we thank you for your support over the years, often sight unseen until we arrive with the bull or the yearly visit to do your selection. This year, please plan to stop in ahead of the sale or the morning of to have a visit. The bull pen will be open anytime for viewing prior to the sale or the morning of the sale. Bulls will all be semen tested, guaranteed and have been on a cereal silage TMR with pea straw, hay and the Bullseye Bull Supplement. Many of these bulls are from the boys' own herd as you will see several tattoos. The boys' herds have been developing since they were nine years old.

On sale day, come early to tour the bulls, have some lunch, enjoy the video sale in our heated building and stay for refreshments following. We also have the option of bidding/viewing online from your home with dlms.ca. We truly believe the cattle business and it's producers will have some bright years ahead, and we look forward to enjoying those with you. Thank you for your time, interest and support. If we can help at all, please call or stop in.

All the Best,
Ken, Josie, Tyson, Riley and Taylor Pashulka
Rusylvia Cattle Co.

SALE DAY INFORMATION

Schedule Of Events

Lunch: 11:30 am
Sale: 1:00 pm
Refreshments: 3:00 pm

Viewing Of The Bulls

Anytime prior to the sale, or sale day morning.

Sight Unseen

Call Ken or anyone of the boys or sale staff and they will gladly assist you.

Delivery

Bulls delivered to central points in Western Canada prior to April 15/23. We highly recommend insuring bulls that are left at the farm following sale day. \$150 will be taken off if the bull is picked up sale day.

Payment

Balance payable sale day. Please call Ken to discuss other arrangements, we will gladly work with purchasers.

US Purchases

We will arrange all health testing and export papers at cost to US buyers. Delivery arrangements will be coordinated to the US Border Vet closest to purchaser. Bulls must be paid in full prior to shipping to the USA.

Video Sale

No animals will be entering the sales ring. Bulls will be penned outside at farm and are available anytime prior to sale for viewing. Buyers may attend the auction at the farm or bid online at dlms.ca

DLMS Sign-On Info www.dlms.ca

To view this sale visit www.dlms.ca, fill out the registration form located under registration and sign up for your free user account and select a username and password. Bidders: to be approved as a bidder, log into dlms.ca and click on the Buyer Approval tab, select the sale you are interested in bidding on and click sign up.

Feed

Bulls are on a TMR ration consisting of Cereal Silage with chopped hay and pea straw with Bullseye Bull Supplement. The bulls are kept in a 20 acre pasture to develop physical fitness and increase mobility.

Herd Health

Rusylvia Cattle Co has been a VBP plus Beef Producer for 12 years. The entire herd follows the Zoetis Program

Calves Birth:
Once pmH, Inforce 3
Vitade and Selenium

Branding:
Ultrabac 7 with Somubac
Inforce3 and One Shot BVD

Weaning:
Ultrabac 7 with Somubac
Bovishield Gold One Shot
Ivomec

Yearling:
Cyclence
Ultrabac 7 & Bovishield

Cows/Heifers:
Ivomec
Ultrabac 7 with Somubac
Scourguard 3kc
Cattlemaster Gold Fp



SALE DAY CONTACTS

Rusylvia Cattle Co.

Ken Pashulka 780-787-0237
Riley Pashulka 780-581-3013
Tyson Pashulka 780-581-3870
Taylor Pashulka 780-581-0788

Bohrson Marketing Services

Riley Bohrson 639-213-7777
Billy Elmhirst 705-761-0896
Jaxon Payne 306-830-0456

Auctioneer

Dan Skeels 403-783-1217

Ringmen

Jim Pulyk 780-787-0646
Bryon Wolters 780-581-8396

DLMS

Mark Shologan 780-699-5082

Sale Consultant

OBI, Mark Holowaychuck 403-896-4990
Blair Jackson 780-853-0069

Insurance

Stockmens Insurance
Larry Toner 306-834-7652
Canadian Farm Insurance
Heather Barr 780-853-7067

Livestock Pictures & Videos

Cattlevids.ca
Mark Shologan 780-699-5082

View The Lots Online

www.dlms.ca
www.rusylviacattleco.com



Bull Sale & Picture Day Help

Riley Pashulka Nick Wasylik
Taylor Pashulka Lee Shologan
Tyson Pashulka Cassidy Daley
Bronwyn Frenzel

Catalog Cover Picture

Charlotte Wasylik

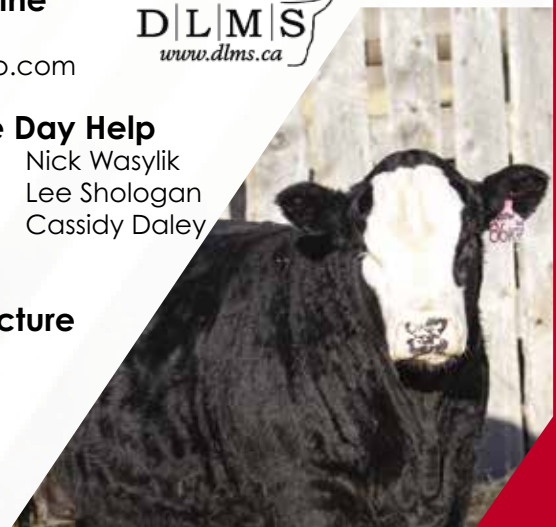

Welcome from BOHRSON MARKETING SERVICES



BOHRSON
MARKETING SERVICES

One of the really great families in the entire livestock industry is the Pashulka's of Rusylvia Cattle Co as they are very hard working, humble people with a sharp eye for quality livestock. We are pleased to once again be working with them in the promotion of their years work as we welcome you to their annual Bull sale.

The Rusylvia program is a family run operation with a large, impressive cowherd including Angus, Mane Anjou and Simmental along side their commercial operation. Their heavy emphasis of Ai and the utilization of embryo transfer has elevated their program into one of the most diverse, consistent, high quality cowherds in Canada. They are always utilizing industry leading bulls to breed with and are forever in the hunt for the next cornerstone donor to build around. You will see many examples of this as you analyze the catalogue and see flush brothers and many half and 3/4 brothers. The bulls on offer are fed with the cowman in mind and are built for the long haul. These bulls are hard muscled and ready to get to work to incorporate their easy doing, low maintenance body type while incorporating the depth of rib, hair and strong maternal qualities bred into them. This set of bulls are so uniquely similar across the trio of breeds and we think you will quickly identify the type and kind of easy doing, high performing bulls the Pashulka's strive to breed. You can rest assured when you choose to buy your next bull or bulls at Rusylvia, they will leave you a heavy set of steers to market and replacement females that will make your neighbours jealous. Again this year they will have a sampling of open commercial females in groups available.

We hope you can make it to the farm near Derwent for the 3rd annual bull sale! The Pashulka's work 365 days a year to ensure a quality product is presented to you March 1. Come for the quality cattle, stay for the big time fellowship and enjoy sorting through this deep set of bulls to source your next herdbull(s). If any of us at Bohrson Marketing can be of any assistance, please reach out and we will gladly visit with you about the offering.

Best regards,
The Bohrson Marketing Team



**Northland Panels &
Bin Moving**

ABE BERG

Myrnam, AB

Cell 780-210-2545

BULL PENNING SUPPLIED BY NORTHLAND PANELS.
Quantity of panels will sell at bull sale!

**S
P
O
N
S
O
R
S**



It is a pleasure working with the great people from Rusylvia Cattle Co on their nutrition program. You will be tough pressed to find a family more dedicated to the agricultural industry. Whether you are in the market for Angus, Simmental, or Maine bulls, you'll be sure to find something in their impressive and consistent bull pen. I hope you can make the sale to see this impressive group.

The cowherd utilizes a customized organic mineral program that is balanced throughout the year. The bull development program is built to maximize forage utilization and gut health. All forages are sampled and analyzed to ensure quality feed sources are used. Once the calves are weaned, they are slowly transitioned to a TMR. The TMR is forage based and is designed to

promote lean muscle growth, allowing the bulls to express their genetic potential. Rumen health is of utmost importance, which is why suitable protein sources and proper starch levels are fed to the bulls. Organic minerals are used both on the cow herd and sale bulls to ensure proper immune function and overall health.

The overall nutritional health of both the bulls and cowherd is of major importance to Rusylvia and it shows in the quality and consistency of their cattle. If you have any questions about the nutrition program, feel free to reach out. Good luck on sale day.

Good luck on sale day!

Ryley Noble
Beef Advisor

(587) 217-9599
ryleynoble@bullseyeteeds.ca

2022 BULL SALE PRICES

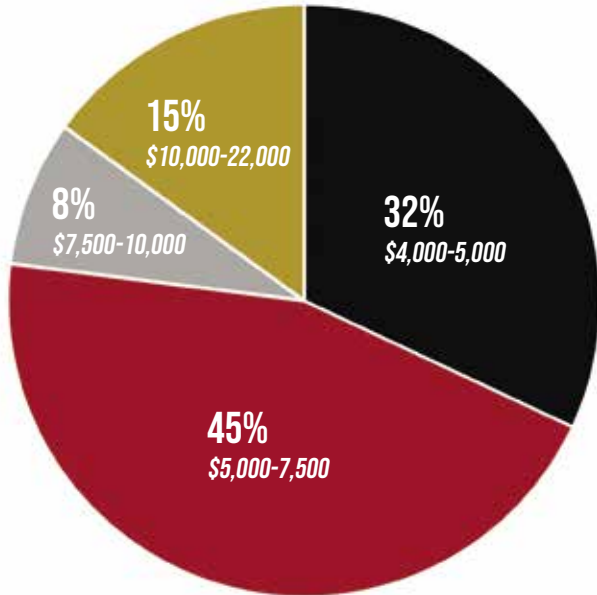

Price Range

Rusylvia bulls are available in a wide range of prices to meet all of our customers needs.



TERMS & CONDITIONS

Terms

Payment in full must be made before cattle can be released and shipped. Exchange rates will be announced sale day and the sale will be held in Canadian funds.

Bidding

In person or online through DLMS.

Announcements

Any announcements made at the time of the sale will take precedence over the printed matter in the catalogue. Buyers are therefore cautioned to pay attention to any such announcements.

Insurance

We strongly recommend the buyer insures for full value on all purchases.

Weaning Weight Date

All weaning weights were recorded on September 10, 2022.

Purchaser's Risk

Each animal becomes the risk of the purchaser as soon as sold.

Health

All sale animals have met all necessary health requirements. Bohrsen Marketing Services assume no responsibility for the health status of any animal in the sale.

Certificate of Registry

A registration certificate issued by the applicable breed association and a certificate of registry duly transferred will be furnished to the buyer of each registerable animal after final payment has been made.

Information Supplied

The information contained in this catalogue is believed to be true and accurate. The seller has provided the information to Bohrsen Marketing Services and they assume no responsibility if the information supplied is not accurate.

Thank you TO LAST YEAR'S BUYERS!

BOULDER BOTTOM+
LES PASHULKA+
RAFTER P RANCH+
TROY SPEERS+
J2 FARM SUPPLIES+
KIZIAK FARMS
BRAD HINES+
LAZY HE FARMS+
SIDE HILL FARMS
WESTMAN FARMS+
VINCE/TYLER CHARCHUN+
LEE SHOLOGAN+

OB HOLDINGS
LAZY J OVER C+
DEAGLE CATTLE *+
PICK 6 MAINES
TERRY CURTIS
LES AND TERRY ELLIOT+
MATT JAREMA
J ANCHOR RANCHES
PLAMONDON FARMS+
BLUE SKY MAINES+
LAURENT/JEFF BELLAND+
CLYDEVIEW FARMS

NEIL DAVIS+
CHATSWORTH+
SUNNYLAKE-ART OKKEMA
NOTT FARMS
MCKENZIE LAND AND CATTLE+
HIDDEN VIEW+
WOCKNITZ FARMS+
COLTHART CATTLE
WE DELIVER SYNDICATE
*VOLUME BUYER
+REPEAT BUYER

1 / MR RUSYLVA YUMA 6K

#1412512 • JANUARY 2 2022 • KJP 6K • HOMO POLLED • PUREBRED

ACT BW	ACT WW	CE	BW	WW	YW	MK	MCE	MWW
90	960	10.1	2.7	91.4	148.8	22.1	5.3	67.8

SIRE: **R PLUS YUMA 9087G**

R PLUS 5015C
MISS R PLUS 3007A

DAM: **SVS BLK SATIN 783E**

MADER WALK THIS WAY 224B
SVS RED SATIN 524C

We could not be happier with starting this year's simmental division off with these impressive \$150,000 R+ Yuma x SVS BLK Statin sons. These four pattern very similar in terms of muscle expression and the extra rib longer. Much like there sire and dam they keep that big awesome square foot under them. Whether you are looking for a red or black bull these ET brothers will definitely be on your short list. Check out their WW and YW EPDs Top 5%.

Full Sibs

2 / MR RUSYLVA YUMA 12K

#1412513 • JANUARY 2 2022 • KJP 12K • POLLED • PUREBRED

ACT BW	ACT WW	CE	BW	WW	YW	MK	MCE	MWW
90	900	10.1	2.7	91.4	148.8	22.1	5.3	67.8

3 / MR RUSYLVA YUMA16K

#1412514 • JANUARY 3 2022 • KJP 16K • HOMO POLLED • PUREBRED

ACT BW	ACT WW	CE	BW	WW	YW	MK	MCE	MWW
82	925	10.1	2.7	91.4	148.8	22.1	5.3	67.8

4 / MR RUSYLVA YUMA 54K

#1412507 • JANUARY 12 2022 • KJP 54K • HOMO POLLED • PUREBRED

ACT BW	ACT WW	CE	BW	WW	YW	MK	MCE	MWW
90	975	9.9	2.3	76.2	121.2	20.1	3.4	58.2



SIRE OF LOTS 1-5



DAM OF LOTS 1-4

5 / MR RUSYLVA YUMA 19K

#1412515 • JANUARY 4 2022 • KJP 19K • POLLED • PUREBRED

ACT BW	ACT WW	CE	BW	WW	YW	MK	MCE	MWW
92	930	9.9	2.3	76.2	121.2	20.1	3.4	58.2

SIRE: **R PLUS YUMA 9087G** R PLUS 5015C
MISS R PLUS 3007A

DAM: **BLACK GOLD MS TULA 58D** RUBY NFF EXCALIBUR 002X
DRAKE TULA 1R

A bull that we have thought a whole lot of since the day he hit the ground. Not only being a super cool black brockle face, its his genetics behind him being off once again the great \$150,000 R+ yuma and the \$40,000 Black Gold Tula 58D donor dam. This is one of the most complete and fault free bulls in the entire offering.



6 / MR RUSYLVA AMIGOS 525K

#1412991 • JANUARY 9 2022 • KJP 525K • HOMO POLLED/HOMO BLACK • PUREBRED

ACT BW	ACT WW	CE	BW	WW	YW	MK	MCE	MWW
100	965	7.8	3.9	80.4	114.1	22	3.3	62.2

SIRE: **WHEATLAND MAN O' WAR 907G** CCLT ALLIANCE 91C
WHEATLAND LADY 519C

DAM: **NUG MISS 17G** SVS CAPTAIN MORGAN 11Z
SKORS MS MAGGIE 206X



6 Full Sibs

7 / MR RUSYLVA AMIGOS 514K

#1412989 • JANUARY 6 2022 • KJP 514K • HOMO POLLED/HOMO BLACK • PUREBRED

ACT BW	ACT WW	CE	BW	WW	YW	MK	MCE	MWW
95	1015	7.8	3.9	80.4	114.1	22	3.3	62.2

8 / MR RUSYLVA AMIGOS 507K

#1412988 • JANUARY 4 2022 • KJP 507K • HOMO POLLED/HOMO BLACK • PUREBRED

ACT BW	ACT WW	CE	BW	WW	YW	MK	MCE	MWW
92	946	7.8	3.9	80.4	114.1	22	3.3	62.2

Three full sib brothers that are absolute powerhouses. Sired by the great \$317,500 Wheatland Man O War and a Maxwell cow sired by Captain Morgan. They topped the scales at weaning at 965, 1015 and 946 respectively. So whether you are looking for a solid black or a blaze face these guys have it. Just imagine the calf crop you would have with a set of bulls like these.

Owned with Mark Land and Cattle, Westman Farms



SIRE OF LOTS 6-11



7



8



9 / MR RUSYLVA WAR 86K

#CA-BPG1412246 • JANUARY 20 2022 • KJP 86K • POLLED • PUREBRED

ACT BW	ACT WW	CE	BW	WW	YW	MK	MCE	MWW
96	840	5.4	3.9	73.8	103.8	24	0.5	60.9

SIRE: **WHEATLAND MAN O' WAR 907G** CCLT ALLIANCE 91C
WHEATLAND LADY 519C

DAM: **KHG RAYNA 192E** JDF SOUL SEEKER 188
KHG CASSADEE 115A

This is a super stout, big middled bull that is gonna to be one heck of a herd bull. His dam has raised cattle that have consistently been in the front end of either sales or at home in the pen and in production.



10 / MR RUSYLVA WAR 90 K

#CA-BPG1412234 • JANUARY 21 2022 • KJP 90K • POLLED • PUREBRED

ACT BW	ACT WW	CE	BW	WW	YW	MK	MCE	MWW
102	895	4.1	5.2	79.2	107.9	21.2	1.4	60.8

SIRE: **WHEATLAND MAN O' WAR 907G** CCLT ALLIANCE 91C
WHEATLAND LADY 519C

DAM: **BOSS LAKE MS ESSENCE 840F** PROFIT
IPU MS. RED ESSENCE 214W

Here is a really high performance bull. One that is definitely a heavyweight in this year's pen and is another son of the \$317,000 Man O' War and his dam is a standout Profit female. We think if you want to add pounds and performance to your herd and also get some chrome, this is your guy.



11 / MR RUSYLVA WAR 96K

#CA-BPG1412235 • JANUARY 23 2022 • KJP 96K • POLLED • PUREBRED

ACT BW	ACT WW	CE	BW	WW	YW	MK	MCE	MWW
100	930	5.9	4	72.7	102.5	23.1	1.7	59.5

SIRE: **WHEATLAND MAN O' WAR 907G** CCLT ALLIANCE 91C
WHEATLAND LADY 519C

DAM: **DESTINY ADMIRAL SOFTWARE** RTC/JETS ADMIRAL 16A
DESTINY 680S SOPRANO

This bull speaks for himself and has since day one. A bull that is an absolute tank and has tons of capacity and natural muscle shape and overall quality and gets out and tracks so well for the power house he is. From a cow that was selected from Ontario by Mark in one of his many trips.

12 / MR RUSYLVA CHARGE 29K

#1412500 • JANUARY 6 2022 • KJP 29K • HOMO POLLED • PUREBRED

ACT BW	ACT WW	CE	BW	WW	YW	MK	MCE	MWW
86	800	7.4	4.3	75.1	113.4	17.4	1.9	55

SIRE: RF SUPERCHARGED 9150G

RF CAPACITY 742E
RF CERTAINLY FLIRTIN 202Z

DAM: BLACK GOLD MS TULA 58D

RUBY NFF EXCALIBUR 002X
DRAKE TULA 1R



12

Full Sibs

Two really high quality individuals off none other than the \$130,000 RF Supercharged and our Black Gold Tula donor. We think these two have a lot to offer to the industry with there long body, big topped and cool look these two have for being big rugged bulls. These are a cowman's bull.



SIRE OF LOTS 12-15



DAM OF LOTS 5, 12 & 13

14 / MR RUSYLVA CHARGE 77K

#CA-BPG1412241 • JANUARY 18 2022 • KJP 77K • POLLED • PUREBRED

ACT BW	ACT WW	CE	BW	WW	YW	MK	MCE	MWW
95	875	5.6	4.6	78.9	114.4	19	1.3	58.5

SIRE: RF SUPERCHARGED 9150G

RF CAPACITY 742E
RF CERTAINLY FLIRTIN 202Z

DAM: MRL MISS 7441E

MRL 36B
MRL MISS 427X



A really exciting black blaze RF Supercharged son. He is big bodied, big boned and big footed. Backed by a great MRL female. This guy will add pounds to your calf crop and will love the females for your replacement pen and while adding that money strip to them.



15 / MR RUSYLVA CHARGE 85K

#CA-BPRS1412245 • JANUARY 20 2022 • KJP 85K • POLLED • PERCENTAGE

ACT BW	ACT WW	CE	BW	WW	YW	MK	MCE	MWW
96	825	7.8	3.9	76.8	116.1	18.8	2.9	57.2

SIRE: **RF SUPERCHARGED 9150G**

RF CAPACITY 742E
RF CERTAINLY FLIRTIN 202Z

DAM: **DAINES MISS BP 27E**

MADER BOILING POINT 45C
DAINES MISS 45X

Here is a bull with some volume and capacity. He is super stout and loose hided and will love the muscle shape and design to this bull. His dam was a past FNL high selling female and hasn't looked back since being a great mature cow with awesome feet and udder. One thing with these Superchargeds, they are consistent and we think good and their offspring will be the same.

This is a pair of bulls that we are super excited to offer to the public and think a lot of these two since the start. We had purchased pregnant recips out of the Wilson Stock Farm Dispersal and boy are we happy with the results. Their dam is the \$29,000 WSF Hoop N Holler donor and progeny has already been firing up the sale ring with having two sons selling for \$26,000 and \$10,500.



16 / MR RUSYLVA 24K

#1412517 • JANUARY 5 2022 • KJP 24K • HOMO POLLED • PUREBRED

ACT BW	ACT WW	CE	BW	WW	YW	MK	MCE	MWW
84	1005	3.9	5.3	98.4	146.3	20.3	1.2	69.5

SIRE: **MRL UNTOUCHABLE 89G**

MRL CAPONE 130B
TSN MS EDITION 55W

DAM: **WSF HOOP N HOLLAR**

WFL WESTCOTT 24C
RF SCREAM 215Z



DAM OF LOTS 16-17

The 24k bull is an absolute beast in terms of volume and capacity and has that extra rib and is all packaged up in a dark cherry red white face package. Check out that weaning weight of 1,005 lbs.



17 / MR RUSYLVA CAPTAIN 44K

#1412506 • JANUARY 8 2022 • KJP 44K • HOMO POLLED • PUREBRED

ACT BW	ACT WW	CE	BW	WW	YW	MK	MCE	MWW
105	950	7.1	4.7	93.1	141.4	21.4	3	67.9

SIRE: **SVS CAPTAIN MORGAN 11Z**

HARVIE JDF WALLBANGER 111X
SUNNYVALLEY BLK JENNA 88U

DAM: **WSF HOOP N HOLLAR**

WFL WESTCOTT 24C
RF SCREAM 215Z

44k is a son of the breed changer Captain Morgan. This guy is in a more moderate package but one that is good haired, big middle and big topped and is just a tank for the amount of capacity he has.

18 / MR RUSYLVA CMAN 88K

#CA-PG1412248 • JANUARY 20 2022 • KJP 88K • HOMO POLLED • PUREBRED

ACT BW	ACT WW	CE	BW	WW	YW	MK	MCE	MWW
96	915	6.5	4.6	91.5	134.2	23.8	4.3	69.6

SIRE: **CINDERELLA MAN** SVS TYCOON 841F
WFL RED SAGE 506C

DAM: **MISS RUSGOLD 144F** MR HOC BROKER
RF CERTAINLY FLIRTIN 526C



This is our first time using Cinderella Man and are we every happy we did. He serviced majority of our red cows and both sexes have been great. This guy is awesome haired, big bodied and with the pedigree backing him on both sides. His dam Flirtin is a great red female with a good udder and is definitely a standout in the Simmental herd. This guy is big scrotaled and is ready to cover some cows. His performance speaks for itself as he is in top 10% of breed for weaning and yearling weight.



SIRE OF LOTS 18-20

19 / MR RUSYLVA CMAN 89K

#CA-PG1412231 • JANUARY 21 2022 • KJP 89K • POLLED • PUREBRED

ACT BW	ACT WW	CE	BW	WW	YW	MK	MCE	MWW
90	810	7.3	3.7	82.7	120.4	23.4	5.6	64.8

SIRE: **CINDERELLA MAN** SVS TYCOON 841F
WFL RED SAGE 506C

DAM: **WFL BLACK HAZEL 828F** WLB BOUNTY HUNTER 365C
WFL BLACK HAZEL 650D



Another impressive Cinderella Man off a great Westway cow that is a Bounty Hunter daughter. Much like his other half brothers he is good haired, big boned and just a very complete and powerful individual.

20 / MR RUSYLVA CMAN 23K

#CA-PG1412240 • JANUARY 4 2022 • KJP 23K • POLLED • PUREBRED

ACT BW	ACT WW	CE	BW	WW	YW	MK	MCE	MWW
90	975	7.4	2.3	81	117.9	26.4	5.7	66.9

SIRE: **CINDERELLA MAN** SVS TYCOON 841F
WFL RED SAGE 506C

DAM: **DOUBLE BAR D RED LADY 592F** DOUBLE BAR D ROYAL 526B
ACS RED LADY HAAS 826U



A big stout, powerful, high performance bull that is backed by one of our most complete and fault free cows. This guy will be one that you will love for the extra body and over mass of body.



SIRE OF LOT 21



DAM OF LOT 21

21 / MR RUSYLVA RANCHER 92K

#1412508 • JANUARY 22 2022 • KJP 92K • POLLED • PUREBRED

ACT BW	ACT WW	CE	BW	WW	YW	MK	MCE	MWW
100	890	6.5	4	94.2	141.4	23.5	3.1	70.6

SIRE: **SVS RANCHER 42H** SVS TYCOON 841F
HLTS SAMMIE

DAM: **MISS R PLUS 9163G** R PLUS 5015C
MISS GJR 45Y

We had the opportunity to buy a pregnant recip and got a really exciting individual here. A little bit of a new and outcross pedigree. He is long bodied, awesome fronted, good built and big bodied those are just some of his great features. His dam is a very high quality R+ female and his sire the \$110,000 SVS Rancher that we had the opportunity to buy a pregnant recip off. We think this guy offers a lot of good and will only get better with time and will see the same with his offspring.



22 / MR RUSYLVA STATE 63K

#1419062 • JANUARY 15 2022 • KJP 63K • POLLED • PUREBRED

ACT BW	ACT WW	CE	BW	WW	YW	MK	MCE	MWW
90	715	11.8	2.1	83.0	125.0	24.9	6.2	66.4

SIRE: **HART STATE OF WAR 056C** WELSH'S WARSAW 312Z
HART MISS 102

DAM: **TSF HONEY 20H** IPU BENTLEY 81F
SVS HONEY 560C

Here is that heifer bull you have been looking for. Deep sided and big middled with natural muscle yet good headed and built for the heifer pen all makes for sleep easy calving. TSF Honey was a heifer Lee picked out at the Triangle Stock Farms Bull Sale and she is well on her way to becoming that next great cow.



23 / MR RUSYLVA 136K

#CA-BPG1412236 • FEBRUARY 15 2022 • KJP 136K • POLLED • PUREBRED

ACT BW	ACT WW	CE	BW	WW	YW	MK	MCE	MWW
96	775	5.7	3.6	86.8	131.8	25	2	68.4

SIRE: **R PLUS 0094H** R PLUS UPPERCUT 6103D
MISS R PLUS 3007A

DAM: **KHG JANIS 245E** RKTS PRAIRIE STORM 1B
KHG MS GOLD 208Z

Younger bull here but definitely does not give up any performance. Definitely a fault free individual that is big and stout and rugged made and one as he matures will sure be a great herd bull. His dam is a great black baldie female that hits a home run each and every year with her offspring. His sire came out of the great R+ operation demanding \$20,000 and is a maternal brother to the great \$150,000 R+ Yuma and adds foot and udder quality while still being awesome made cattle.



SIRE OF LOT 23 & 24

24 / MR RUSYLVA 145K

#CA-BPG1412237 • FEBRUARY 18 2022 • KJP 145K • HOMO POLLED • PUREBRED

ACT BW	ACT WW	CE	BW	WW	YW	MK	MCE	MWW
90	805	9.7	1.8	89.1	139.5	22.2	5.8	66.8

SIRE: **R PLUS 0094H**R PLUS UPPERCUT 6 103D
MISS R PLUS 3007ADAM: **MISS RUSGOLD 4E**LFE THE RIDDLER 323B
MADER SUGAR ADDICTION 38C

Another great son off our walking R+ herd sire and off a great young female that is just starting her track record with some great offspring retained in the herd already. His grandmother was a past \$24,000 FNL high seller, and the apple does not fall far from the tree with this guy's power and completeness and for a younger bull definitely doing what he needs to do and competing with some of the best in the pen.

**25 / MR RUSYLVA LOADED 200J**

#1412510 • SEPT 25 2021 • KJP 200J • HOMO POLLED/HOMO BLACK • PUREBRED

ACT BW	ACT WW	CE	BW	WW	YW	MK	MCE	MWW
88	870	11.7	2.1	75.5	112.4	19.7	6.1	57.5

SIRE: **W/C LOADED UP 1119Y**REMINGTON LOCK N LOAD 54U
AUBREYS BLACK BLAZE IIIDAM: **JGLADY D308**MR TR HAMMER 308A ET
WF FOREVER LADY Z165

If you're in the market for a bull with a little more age to cover a few more cows then look no further because this guy is one heck of an individual. He's off the great breed legend Loaded Up and of a great dam from Canadian Donors and KT Ranches she was part of NWSS Simmental Sale. This guy is packed with muscle and is long bodied, big topped and big scrotaled.



DAM OF LOT 25

**26 / MR RUSYLVA 112K**

FEBRUARY 1 2022 • KJP 112K • HOMO POLLED • SIMANGUS

ACT BW	ACT WW	CE	BW	WW	YW	MK	MCE	MWW
88	722	-	-	-	-	-	-	-

SIRE: **BROOKING BANKNOTE 4040**CONNEALY EARNAN 076E
E A ROSE 918DAM: **MISS RUSGOLD 144F**MR HOC BROKER
RF CERTAINLY FLIRTIN 526C

Here is a half blood ET bull that is definitely bringing the best of both breeds to the table. This guy is a big middled, stout individual in a more moderate package. His sire Brooking Banknote needs no introduction and has been siring high quality cattle for a long time around the world. His dam is once again our great Flirtin donor going back to HOC Broker and our RF Certainly Flirtin 526C donor. This guy will be one that everybody has marked down. *Can be registered if buyer chooses.*





27

27 / RUSYLVIA MR AMERICA 9K

#2269135 • JANUARY 14 2022 • RPP 9K

ACT BW	ACT WW	CE	BW	WW	YW	MK	MCE	SC
88	900	-2	4.1	74	126	21	0	1.09

SIRE: S A V AMERICA 8018

S A V PRESIDENT 6847
S A V MADAME PRIDE 0075

DAM: S A V BLACKCAP MAY 1420

RITO 707 OF IDEAL 3407 7075
S A V BLACKCAP MAY 4136



28

28 / RUSYLVIA MR AMERICA 20 K

#2269178 • JANUARY 16 2022 • RPP 20K

ACT BW	ACT WW	CE	BW	WW	YW	MK	MCE	SC
90	820	-2	4.1	74	126	21	0	1.09

29 / RUSYLVIA MR AMERICA 40K

#2269130 • JANUARY 19 2022 • RPP 40K

ACT BW	ACT WW	CE	BW	WW	YW	MK	MCE	SC
90	785	-2	4.1	74	126	21	0	1.09



29

Here's a trio of feature bulls in this year's Angus division. These SAV America sons are big, stout, rugged, made bulls full of performance and style. If you're in the market for an Angus bull this spring, these will check all your boxes. Bulls with added power and mass, yet can get out and move on a great set of feet and legs. We purchased these embryos out of the New Year's Resolution Sale from KT Ranch, going 4/4 on the embryos with a full sib heifer, one of the highlights of the replacement pen.

Owned with Chatsworth Land and Cattle

Full Sibs



SIRE OF LOTS 27-29



30 / RUSYLVA MR HARVESTOR 25K

#2259806 • JANUARY 17 2022 • TPP 25K

ACT BW	ACT WW	CE	BW	WW	YW	MK	MCE	SC
88	930	5	2.8	58	104	25	6	0.69

SIRE: **S A V HARVESTOR 0338**

S A V HERITAGE 6295
S A V EMBLYNETTE 7749

DAM: **RUSYLVA MISS 7E**

SOO LINE MOTIVE 9016
RUSYLVA MISS 3C



Our Harvester sons have always been a standout in our bull pen and this year is no exception. Here's a great son out of SAV Harvester and a phenomenal Soo Line Motive daughter. This bull has herd sire written all over him, being a deep sided, long made bull. If you're looking to add performance, and hair coat to your calf crop without sacrificing calving ease, this is the bull for you. Check out that weaning weight of 930 lbs.

31 / RUSYLVA MR HARVESTOR 78K

#2259803 • JANUARY 31 2022 • TPP 78K

ACT BW	ACT WW	CE	BW	WW	YW	MK	MCE	SC
90	830	4	3.7	61	108	24	8	0.95

SIRE: **S A V HARVESTOR 0338**

S A V HERITAGE 6295
S A V EMBLYNETTE 7749

DAM: **RUSYLVA MISS 3C**

S A V FINAL ANSWER 0035
RUSYLVA MISS 93A



Another great SAV Harvester son that is more moderate in his makeup yet offers you the additional shape and stoutness and has the additional rib shape and muscle that you look for in a bull and beyond that you will admire him for how he gets out and tracks so well.



SIRE OF LOTS 30 & 31



32 / RUSYLVA MR FIREBRAND 35K

#2269169 • JANUARY 19 2022 • RPP 35K

ACT BW	ACT WW	CE	BW	WW	YW	MK	MCE	SC
89	840	2.5	2.9	49	83	23	8	0.71

SIRE: **BROOKING FIREBRAND 6068** BROOKING BANK NOTE 4040
BROOKING ANNIE K 390

DAM: **MISS RUSYLVA 4X** S A V NET WORTH 4200
WESTERN TIPPY 7P



We have continued to use Firebrand for the consistency and quality he offers. This mating comes from our top Angus donor Miss Rusylva 4x, a direct SAV Net Worth daughter. He is a super stout, deep bodied and good haired future herdsire.



SIRE OF LOTS 32 & 33

33 / RUSYLVA MR FIREBRAND 46K

#2263658 • JANUARY 20 2022 • KJP 46K

ACT BW	ACT WW	CE	BW	WW	YW	MK	MCE	SC
90	800	1	3	56	93	24	8	

SIRE: **BROOKING FIREBRAND 6068** BROOKING BANK NOTE 4040
BROOKING ANNIE K 390

DAM: **RUSYLVA MISS 31C** S A V FINAL ANSWER 0035
RUSYLVA MISS 36A



A bull that you will admire for his natural presence combined with being soft made and deep sided. He comes off a great SAV Final Answer daughter that is a picture perfect cow for body type, udder and feet. We feel this bull brings a lot to the table in term of overall quality.



34 / RUSYLVA MR NATURAL LAW 106K

#2269171 • FEBRUARY 06 2022 • RPP 106K

ACT BW	ACT WW	CE	BW	WW	YW	MK	MCE	SC
92	800	4	2.9	47	86	22	8.5	0.58

SIRE: **BAR-E-L NATURAL LAW 52Y** S A V BISMARCK 5682
BAR-E-L MAGNOLIA 143K

DAM: **MISS RUSYLVA 4X** S A V NET WORTH 4200
WESTERN TIPPY 7P

35 / RUSYLVA MR NATURAL LAW 109K

#2269163 • FEBRUARY 08 2022 • RPP 109K

ACT BW	ACT WW	CE	BW	WW	YW	MK	MCE	SC
86	780	4	2.9	47	86	22	8.5	0.58

This is a set of very high quality ET bulls that come off our top Angus donor Miss Rusylva 4x and boy are we happy with the results of this flush. Their sire needs no introduction to the Angus breed – Bar-E-L Natural Law 52Y is known for siring some of the best out there. His females are unbeatable and the bulls are bred for this business. These two bulls pattern very similar. They are big bodied, stout made, awesome haired and get out and move without missing a track. We would almost guarantee that you will keep every female off these two, and, not only that, will sire high quality bulls and your heavy weight steers.



SIRE OF LOTS 34 & 35



Full Sibs





36 / RUSYLVA MR FINAL ANSWER 22K

#2259500 • JANUARY 17 2022 • KJP 22K

ACT BW	ACT WW	CE	BW	WW	YW	MK	MCE	SC
86	775	6	2.2	53	95	19	7	

SIRE: **S A V FINAL ANSWER 0035** SITZ TRAVELER 8180
S A V EMULOUS 8145

DAM: **RUSYLVA MISS 9H** S A V RESOURCE 1441
MISS RUSYLVA 18Z

Just like always, we have a few SAV Final Answer sons up for offer this year, and there is a reason why these cattle make it for the sale cut every year. With the overall quality and consistency of these Final Answer sons it hard not to love them. But one of the biggest things is the calving ease they all offer. This guy comes to you with a ton of volume and capacity and moves out great but is built for the heifer pen with his great skull shape and awesome front end. This will be one everyone has marked down.



37 / RUSYLVA MR FINAL ANSWER 11K

#2259706 • JANUARY 15 2022 • RPP 11K

ACT BW	ACT WW	CE	BW	WW	YW	MK	MCE	SC
75	720	10	0.1	53	91	21	10	

SIRE: **S A V FINAL ANSWER 0035** SITZ TRAVELER 8180
S A V EMULOUS 8145

DAM: **RUSYLVA MISS 64H** BROOKING SILVER LINING 5012
BOBO JUNE 0690

Sleep-easy calving will be your first thought when seeing this guy. As usual another super good Final Answer son that is built for the heifer pen yet does not give up the power, mass and capacity and overall herd bull look. This guy's dam is a picture-perfect female and definitely an up and coming pasture front cow here.



38 / RUSYLVA MR FINAL ANSWER 50 K

#2259772 • JANUARY 25 2022 • TDP 50K

ACT BW	ACT WW	CE	BW	WW	YW	MK	MCE	SC
88	810	3	2.5	54	94	21	4	

SIRE: **S A V FINAL ANSWER 0035** SITZ TRAVELER 8180
S A V EMULOUS 8145

DAM: **RUSYLVA MISS 164H** SOO LINE MOTIVE 9016
RUSYLVA MISS 64F

Another real impressive Final Answer son and one that is as good as his pedigree being off a Soo Line Motive cow and Final Answer is a no brainer for the heifer pen. He was bred for it on both sides and his quality says it too. One that is good looking, super sound and yet has the power and muscle shape we look for in a bull prospect. If you're in the market for a heifer bull this spring be sure to have this guy marked because you will not want to miss the opportunity to own one with breeding and conformation.

39 / RUSYLVA MR RESOURCE 70 K

#2263657 • JANUARY 30 2022 • KJP 70K

ACT BW	ACT WW	CE	BW	WW	YW	MK	MCE	SC
90	880	2	3.8	59	113	19	4	

SIRE: **S A V RESOURCE 1441** RITO 707 OF IDEAL 3407 7075
S A V BLACKCAP MAY 4136

DAM: **RUSYLVA MISS 28B** S A V HARVESTOR 0338
DBRL BLACKCAP 55R



Here is a great SAV Resource son. One that we think everyone will pick out when they first walk into the pen for the amount of body, shape and overall quality. He has an awesome look to him. He is coming off a great SAV Harvester daughter that has been one of the most consistent cows in the angus division with always bringing either a bull in the bull sale or a replacement female.

40 / RUSYLVA MR LUCKNOW 65K

#2259577 • JANUARY 29 2022 • KJP 65K

ACT BW	ACT WW	CE	BW	WW	YW	MK	MCE	SC
82	765	5	2.1	70	121	27	8	

SIRE: **GF LUCKNOW 9056** MUSGRAVE 316 STUNNER
GF JENA 905E

DAM: **JL ATLANTAS 0119** S A V RAINFALL 6846
JL ATLANTAS 8031



For those looking for a complete outcross in the heifer pen, this is it. Being a great son of GF Lucknow and off a SAV Rainfall cow, this guy is packed with calving ease yet when studying him in his entirety he is a powerhouse that is soft made, easy doing and is built right for the heifer pen. We only used his sire a couple times, but seeing the results you can bet to sure you'll see a lot more of these cattle.

41 / RUSYLVA MR DENSITY 82K

#2259583 • FEBRUARY 02 2022 • KJP 82K

ACT BW	ACT WW	CE	BW	WW	YW	MK	MCE	SC
88	765	5	3	48	82	23	3	

SIRE: **S A V 004 DENSITY 4336** S A V 8180 TRAVELER 004
S A V MAY 7238

DAM: **MISS RUSYLVA 78Z** DBRL FREE WHEELER 69W
MISS RUSYLVA 17X



Here is a bull that we think could lead off the whole Angus division this year. Being a direct son of SAV Density we are excited to see this guys future and what he does to the operation he goes to. He has the body and natural muscle to sire your heavy weights come fall but also to make you foundation females. This is a real exciting young herd sire.

42 / RUSYLVA MR GOLD COIN 144K

#2259604 • FEBRUARY 28 2022 • KJP 144K

ACT BW	ACT WW	CE	BW	WW	YW	MK	MCE	SC
90	760	1	3.5	56	96	25	6	

SIRE: **BROOKING GOLD COIN 0077** BROOKING GOLD COIN 8069
MICH ENVIOUS BLACKBIRD 1449

DAM: **RUSYLVA MISS 72B** DURALTA 80M YELLOWSTONE 81Y
MVF ERROLLINE 359U



Youngest bull in the offering but boy you would not tell that by looking at him. He is an absolute tank for his age with his extra rib and big middle. He is off a great herd sire we had the opportunity to buy from Brooking Angus being a Brooking Gold Coin son and off the very famous Mich Envious Blackbird 1449 cow. We really think a lot of this younger bull and know that he will do nothing but good as he matures.

LOT 43: FEATURE



If you're looking for that next great outcross bull then here he is. 68K will be the first Databank bull to sell in Canada. He even has the track record to make him proven. He was grand champion bull calf and overall reserve champion bull at Farmfair and Agribition. He also won the Maine division of the President's Classic Bull Show at Agribition. This guy is truly a herd bull in the making with explosive muscle shape, performance and size. Backed by a dam that consistently produces the good ones.

43 / MR RUSYLVA 68K

#522784 • JANUARY 30 2022 • RLP 68K • POLLED • PUREBRED

ACT BW
90

ACT WW
815

TH/PH FREE

SIRE: **BNWZ DATA BANK 1311C ET**

BBBN X2 201X
BNWZ CALYPSO 28Y

DAM: **MISS RUSYLVA 12Z**

GVC SUH 01W
MISS RUSYLVA 5W



GRAND CHAMPION BULL CALF AND OVERALL RESERVE CHAMPION BULL AT FARMFAIR INTERNATIONAL AND CANADIAN WESTERN AGRIBITION & PRESIDENT'S CLASSIC MAINE CHAMPION AT CANADIAN WESTERN AGRIBITION.

LOT 44: FEATURE



44 / MR RUSYLVA 30K

#522776 • JANUARY 20 2022 • KJP 30K • PUREBRED

ACT BW
90

ACT WW
785

TH/PH FREE

SIRE: **BNWZ DATA BANK 1311C ET**

BBBN X2 201X
BNWZ CALYPSO 28Y

DAM: **MISS RUSYLVA 36A**

MR STYLE X MAN 21X
NLC POPSTAR 36P

Here's another total outcross bull sired by Databank. His Dam 36A is a total outcross to anything we have. So, if you're looking for a bull to cross with any SUH or Benelli bloodline you should consider this guy. He is moderate framed and thick muscled. 30K was shown at Agribition taking Reserve Bull Calf Champion honours.



SIRE OF LOTS 43 & 44

RESERVE BULL CALF CHAMPION AT CANADIAN WESTERN AGRIBITION



45 / MR RUSYLVA 74K

#R522769 • JANUARY 31 2022 • KJP 74K • POLLED • 3/4 MAINE

ACT BW 90 ACT WW 750

SIRE: DUEL ICON 802F

BOE EPIC
DUEL WORRY NOT 4303B

DAM: MISS RUSYLVA 80E

MR RUSYLVA BENNILLI 6B
MISS RUSYLVA 71Y



SIRE OF LOT 45

Here is truly a unique purebred bull not only being a different pedigree but having that white baldy face. This was our first calf crop using Duel Icon and he left some keepers.



46 / MR RUSYLVA 120K

#R522781 • FEBRUARY 18 2022 • RLP 120K • POLLED • 3/4 MAINE

ACT BW 92 ACT WW 800

SIRE: DJS FIGHTIN IRISH 747E

BFW FIGHTIN IRISH
KKS MISS METRIC 739T

DAM: MISS RUSYLVA DIAMOND 814D

MONOPOLY 07S
MISS RUSYLVA AINT SHE PRETTY

Well Riley's famous "Diamond" cow has done it again. We all know how much that cow won at every show she was entered at and she continues on with raising great progeny as well. 120K adds to the wall of fame with his achievements as a calf being Grand Champion Maintainer Bull at both Farmfair and Agribition. His disposition follows in his mother's footsteps as the quietest and easiest animals in the herd to work with. Sired by our walking bull "Irish" the pedigree will go on to sire some champions in the show ring and sales ring. Being a 3/4 Maintainer this guy will leave you with a purebred calf on any purebred cows. He will be a performance bull as he weaned off at 800lbs.



GRAND CHAMPION MAINTAINER BULL AT FARMFAIR INTERNATIONAL AND CANADIAN WESTERN AGRIBITION

47 / MR RUSYLVA 128K

#R522777 • FEBRUARY 22 2022 • KJP 128K • POLLED • 3/4 MAINE

ACT BW 100
ACT WW 700

SIRE: **DJS FIGHTIN IRISH 747E**

BFW FIGHTIN IRISH
KKS MISS METRIC 739T

DAM: **MISS RUSYLVA 71Y**

MANITOBA NEU 836U ANGUS
MISS GEE BAR 222M

One of the youngest bulls but he's proving to be big on performance. Out of one of our best cows – 71y is a big, solid tank of a cow with lots of milk. His sire "Irish" is a big, powerful bull that was unbelievably long and very clean fronted, which we unfortunately lost due to a lightening strike. His calves always had performance and a great look about them. Don't miss out of this bull.



48 / MR RUSYLVA 137K

#522767 • MARCH 1 2022 • KJP 137K • POLLED • PUREBRED

ACT BW 85
ACT WW 720

SIRE: **DJS FIGHTIN IRISH 747E**

BFW FIGHTIN IRISH
KKS MISS METRIC 739T

DAM: **MISS RUSYLVA 28G**

BPF COMFORT ZONE
MISS RUSYLVA 79E

The youngest bull in the offering yet has been gaining well all winter and keeping up with the older boys. His dam is a great young cow that is sired by Comfort Zone and his sire is our "Irish" bull.



Can't make it to the sale? Watch & Bid Online.

With DLMS you can Watch, Listen & Bid on your computer just like you were there with online bidding over the internet

Instructions for Viewing And Bidding At the Sale

Visit www.dlms.ca, Fill out the registration form located under registration and sign-up for your free user account to select a username and password.

BIDDERS - To be approved as a bidder, Log in and click BUYER APPROVAL tab, select the sale you are interested in bidding at and click sign up.

For more information or for help getting approved Call:

Mark Shologan - 780-699-5082 or DLMS Purebred Team 780.991-3025

Direct Livestock Marketing Systems
We're Making the Connection

DLMS
www.dlms.ca

To find an agent or sale near you today
visit www.dlms.ca

Purebred Sales • Daily Presort Sales
Direct Off-farm Sales every Thursdays at 10:00 am





49 / MR RUSYLVA 3K

#R522764 • JANUARY 15 2022 • KJP 3K • POLLED • 1/2 MAINE

ACT BW 78 ACT WW 770

SIRE: SOO LINE MOTIVE 9016 (ANGUS)

DAM: MISS RUSYLVA 78H

MR RUSYLVA BENNILLI 6B
MISS RUSYLVA SASSY 42S

Off a Benelli daughter we showed that was Champion Yearling at Farmfair and Reserve Champion at Agribition last year. This guy has that hybrid vigour you will like as your next herd sire, complimenting both the Maine and Angus breeds. This being off a first calf heifer his mother batted a home run on her first try.



SIRE OF LOTS 49 & 50



DAM OF LOT 49



50 / MR RUSYLVA 37K

#R522763 • JANUARY 20 2022 • KJP 37K • POLLED • 1/2 MAINE

ACT BW 75 ACT WW 730

SIRE: SOO LINE MOTIVE 9016 (ANGUS)

DAM: MISS RUSYLVA 74H

NMR MATERNAL MADE
MISS RUSYLVA 81E

His dam is a Maternal Made daughter and our go-to calving ease Angus bull Soo Line Motive. Easy calving yet lots of performance in their calves. If you're looking for a Maine/Angus sire make sure you check this guy and his paternal brother 3K out. They won't disappoint.

Bulls are **EASY TO VIEW ON SALE DAY** //

51 / MR RUSYLVA 57K

#522774 • JANUARY 26 2022 • KJP 57K • POLLED • PUREBRED

ACT BW 90 ACT WW 830

SIRE: **HALL'S SIR ARCTIC POWER 281H** KOHLHAUSER'S ARTIC POWER 36E
KOH MIDNIGHT CINDERELLA 281F

DAM: **MISS RUSYLVA 015E** GVC SUH 01W
MISS RUSYLVA 36U

We wanted to get some outcross and different genetics we could use on our SUH and Benelli daughters, so we went into the AI tank to get some older, proven genetics. This one being a red purebred Arctic Power so mating this to some red cows there will be a great chance of getting red calves. The older genetics have brought some added performance as he weaned off at 830lbs.



DAM OF LOT 51

52 / MR RUSYLVA 84K

#R522775 • FEBRUARY 03 2022 • KJP 84K • POLLED • 1/4 MAINE

ACT BW 80 ACT WW 815

SIRE: **CSCX BANDWAGON 513A SIMMENTAL**

DAM: **MISS RUSYLVA 80C** MAN AMONG BOYS
MISS RUSYLVA 80T

Here's a different twist to pedigree as 84K is sired by the 3/4 Simmental bull Bandwagon. This guy even comes with the money strip on his forehead. Another performance bull with a weaning weight of 815lbs.



53 / MR RUSYLVA 99K

#522785 • FEBRUARY 06 2022 • TDP 99K • POLLED • PUREBRED

ACT BW 82 ACT WW 750 CE 7 BW 2.1 WW 45.1 YW 59.2 MK 16.8 TM 39.2 MCE -1.5

SIRE: **MR RUSYLVA BENELLI 6B** GVC SUH 01W
MISS RUSYLVA 36U

DAM: **MISS RUSYLVA 7Z** BPSL BOOMER 1U
MISS RUSYLVA SASSY 42S

Off our only red cow 7Z, this cow has never missed to her Benelli mating so we keep breeding her the same way. First time in four years that we got a bull, so we are offering 99K. She has never missed in all her years of AI services, so she has very fertile genetics. This bull definitely has a herd sire look to him and will work well in either a purebred or commercial herd.



SIRE OF LOT 53





8 LOTS OF 3-5 OPEN COMMERCIAL HEIFERS

54 / 55 / 56 / 57 / 58 / 59 / 60 / 61

THESE HEIFERS ARE FROM THE TOP OF OUR COMMERCIAL HERD. WE WILL SORT THEM INTO GROUPS OF 3 OR 5 FOR UNIFORMITY. THE GROUPS WILL CONSIST OF ANGUS X, ANGUS/SIMMENTAL, AND ANGUS/MAINE.





WE DELIVER SYNDICATE GROUP
 GOLDEN OAK LIVESTOCK
 WESTMAN FARMS
 JIM PULYK
 W2 LAND AND CATTLE
 BOULDER BOTTOM STOCK FARMS
 BLACKGOLD SIMMENTAL
 LEWIS FARMS
 MAXWELL SIMMENTALS
 EVERBLACK ANGUS
 WESTWAY FARMS
 J K BAR CATTLE

MR RUSYLVA **WE DELIVER** 39J



CANADIAN WESTERN AGRIBITION GRAND CHAMPION BULL AND TOP 10 SUPREME, FARMFAIR INTERNATIONAL GRAND CHAMPION BULL, NATIONAL WESTERN STOCK SHOW RESERVE GRAND CHAMPION BULL & STOCKADE ROUNDUP GRAND CHAMPION BULL AND TOP 4 SUPREME





BOHRSON MARKETING SERVICES

RR4 :: SITE 7 :: BOX 28
OLDS, ALBERTA :: T4H 1T8

If you wish to stop receiving catalogs from BMS, please email info@bohrson.com or call 781-451-574-1415 to be removed from the mailing list.



RETURN POSTAGE GUARANTEED
POST DE RETOUR GARANTIE

RUSYLVA CATTLE CO.

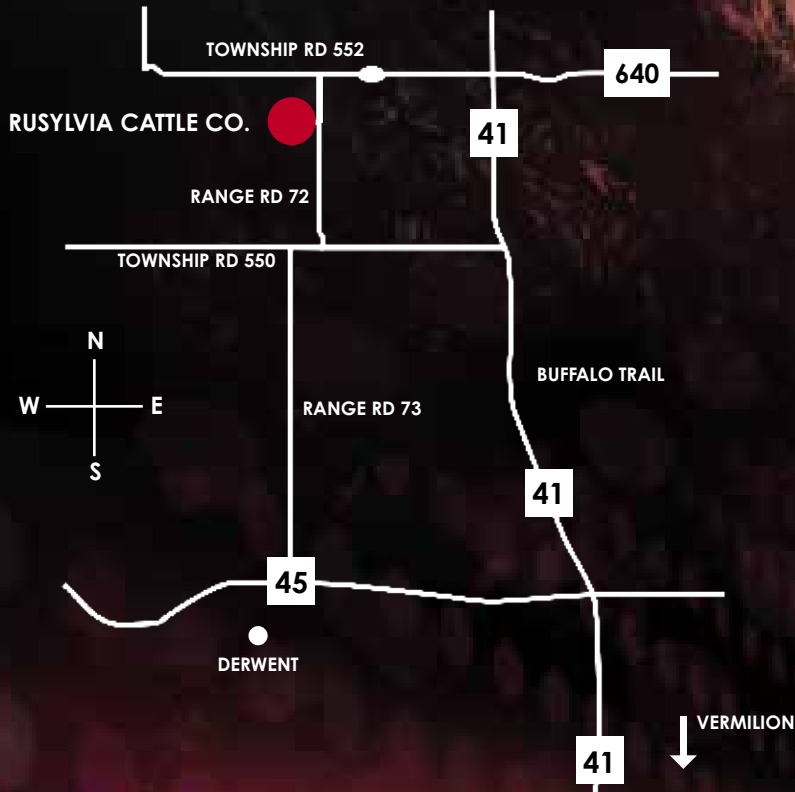

Directions

- GPS 551034 County of Two Hills
- Vermilion North
- Hwy 41 North until Hwy 640 Junction.
- Turn west (Rusylva Cattle Co. Sign along Hwy)
- 2 miles until Range Road 72.
- Go south on Range Road 72 for ¾ of a mile look for Red/White Buildings with a gate sign.